

06/2021

	contains	m ²	ft ²	weight
1 pack Chateau	24 planks	1,02 m ²	10.94 ft ²	7,3 kg
1 pallet Chateau	48 packs	48,77 m ²	524.97 ft ²	365 kg

product specifications

Dimensions	504 x 84 mm
Total thickness	8 mm
Bevels	4
Loc System	Chateau Loc - type A and type B
Level of use according to European standard EN10874	23 heavy domestic use
	32 general commercial use
Residential warranty	lifetime
Commercial warranty	5 years

Warranty conditions on www.berryalloc.com.

composition

Surface layer	Direct laminated paper, impregnated with melamine resin.
Substrate	Moisture resistant High Density Fiberboard (HDF).
Backing	Direct laminated paper, impregnated with melamine resin.

test results

Abrasion resistance	EN13329	AC4 (IP≥4000)
Impact resistance	EN13329	Small ball : ≥ 12 N - Big ball : ≥ 750 mm
Thickness swelling	EN13329	12% (requirement ≤ 18%)
Fire resistance	EN14041	Cfl-S1
Formaldehyde emission	EN14041	E1
Slip resistance	EN14041	DS
Density	EN323	900 kg/m ³
Resistance to staining	EN438	5 (groups 1+2) ; 4 (group 3)
Effect of a furniture leg	EN424	No damage (foot type 0)
Effect of a castor chair	EN425	No change in appearance or damage
Thermal resistance in combination with underlay Excellence Plus	ISO 8302	0,08 m ² K/W – Suitable for floor heating/cooling. Detailed instructions on www.berryalloc.com

certificates/labels

- DOP : 170-DPLA18-1
- Sustainability of forests : PEFC certified (07-31-229)
- Labelling according to French VOC emission regulation: A

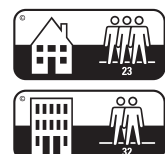
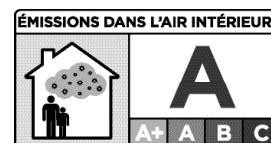

*Information sur le niveau d'émission de substances volatiles dans l'air intérieur, présentant un risque de toxicité par inhalation, sur une échelle de classe allant de A+ (très faibles émissions) à C (fortes émissions).

Class 23/32: The **CHATEAU** laminate floor is designed for:

- Heavy domestic use: bedrooms, living rooms, kitchens, entrances
- General commercial use: classrooms, small offices, hotels, boutiques



Chateau is a unique laminate that can be installed in multiple patterns thanks to the exclusive Chateau locking system developed by BerryAlloc engineers:

- The "**Herringbone**" and "**Mosaic**" patterns require two plank types: A planks and B planks. These are packaged separately, so do not forget to notify your BerryAlloc dealer that you require both types if you choose this pattern.
- The "**Shipdeck**" and "**Ladder**" patterns only require one plank type: the A planks.
- The Chateau "**Herringbone**" and "**Shipdeck**" patterns are designed for floating installation, but can also be fully glued to the subfloor without underlay.

For a perfect result that meets the warranty requirements, we advise you to carefully follow the installation instructions listed below.

1. planning your installation

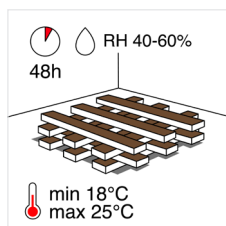

It is necessary to store the laminate boxes at room temperature for at least 48 hours before installation. Do not open the packs but make sure to stack them so they have maximal air contact.

The floor should be installed at a room temperature of 18-25°C and a relative humidity of 40-60%.

tools

- electrical or hand saw
 - spacers
 - measurement tool and pencil, T-square, fast-drying PVAc wood glue type D3
- For your safety, use protective clothing: gloves, dust mask, protective glasses.

Do not forget the matching skirtings and finishing profiles (doorways, transitions to other floors,...).

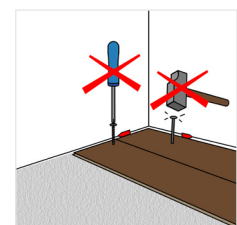
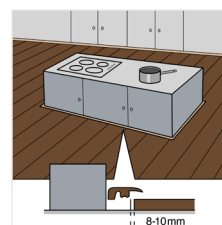
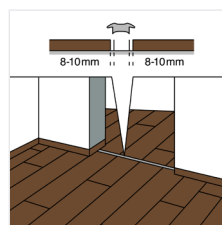
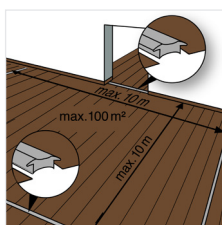
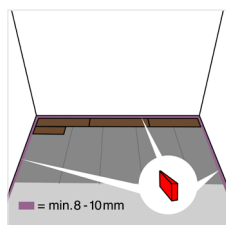

Chateau can be installed as a floating floor, or can be fully glued to the subfloor, depending on the floor pattern.

- Do not screw the floorboards to the subfloor.
- Do not install the laminate floor under fixed constructions such as kitchen cabinets or built-in closets.
- Leave a 8-10 mm expansion gap between walls and other fixed constructions so that the floor can move.
- Always install expansion profiles in doorways.
- Install expansion profiles in areas that do not join symmetrically and when the room length/width exceeds 10 m.

2. preparing the subfloor

BerryAlloc laminate can be installed on most hard subfloors, e.g. chip/plasterboards, PVC, or concrete (keep in mind to verify if the existing subfloor construction is fixed).

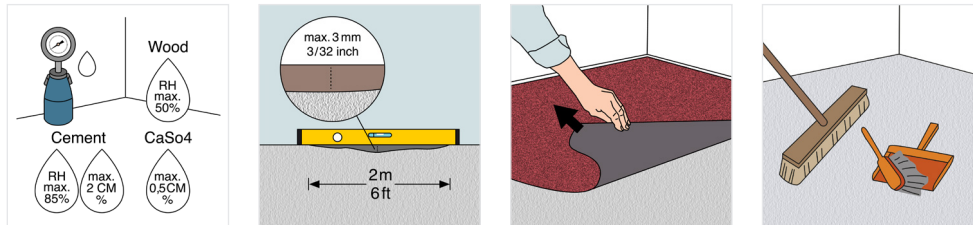

The subfloor must be totally dry:

- Wooden and wood based material, max. 50 % relative humidity
- Concrete and light concrete floor, max. 2,0 CM % (1,8 CM % if floor heating)
- Plaster and plaster based floor, max. 0,5 CM % (0,3 CM % if floor heating)

The subfloor has to be even (max. height difference of 3 mm per 2 m).

Smoothen sharp edges and fill any holes.

This is important because an uneven subfloor can cause squeaking noises.

Soft material like a wall-to-wall carpet needs to be removed.

Clean the subfloor before you start the installation.

On an existing wooden floor, BerryAlloc laminate should be installed perpendicular to the old floorboards.

3. floor heating/cooling

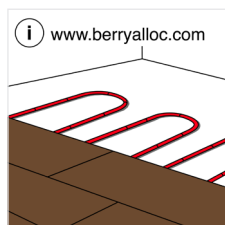

If you have a subfloor heating system, be sure to read our separate manual for installing laminate on top of floor heating.

4. underlays

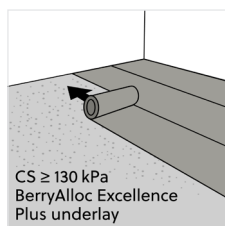

BerryAlloc underlays are specially developed for our floors, and with the same high quality standards, to ensure a perfect result. The specific design of the Chateau planks requires a high performance underlay with a compression strength of min. 130 kPa. The BerryAlloc Excellence Plus underlay is the perfect base for the herringbone and shipdeck installation.

In fully glued installations, the laminate floor has to be glued to the subfloor. In that case, you cannot use an underlay.

5. installing your Chateau floor



Check all planks for visible defects in optimal light conditions, both before and during installation. Planks with defects must not be used.

For the most natural floor pattern, make sure to mix the designs of the planks throughout the installation.

Chateau is a dream floor for creative installers. Multiple patterns are possible, and a wide variety of colors allows you to mix and match, and add some personality to your royal floor: **herringbone**, **shipdeck**, **ladder**, and **mosaic**.

5.1 the herringbone pattern

scan the QR code for the full herringbone installation video:

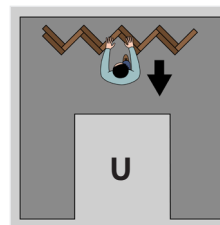
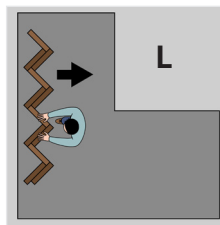
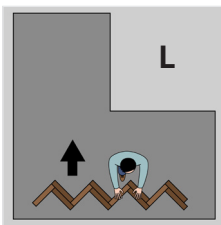
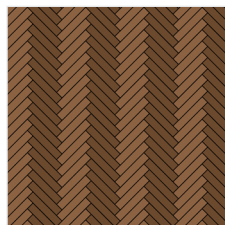

Consider the shape of your room when you choose your start wall. For L- or U-shaped rooms, please check the illustrations.

For the herringbone pattern, you'll need two plank types: A planks and B planks. Take a plank and turn the side with the long groove towards you. The groove continues along the short side to the RIGHT for A planks, and to the LEFT for B planks. Always make sure the grooves are pointing towards the laying direction.

All planks are marked with "A" or "B" on the back.

We strongly recommend applying a fast-drying wood glue to both short sides of the planks for optimal floor stability.

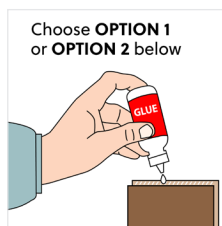
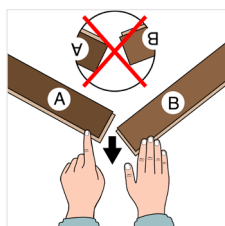
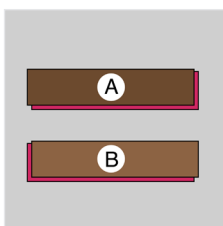

Start making V-shapes along the starting wall with an A plank (1) in a 45° angle, connect it with a B plank (2), and then add another A plank (3) to the left again, to secure the connection. Continue to the right adding another A plank, and so on. Begin and end with a full V-shape.

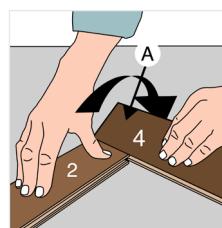
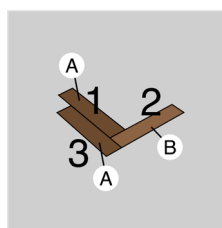
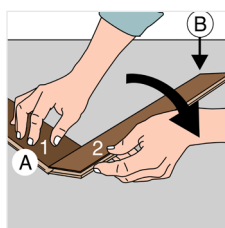
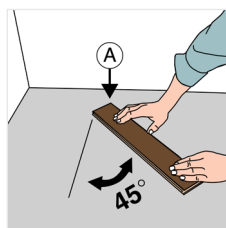

Continue the installation by adding B and then again A planks, until you have finished at least 4 rows. Determine the center of the starting wall and the center of your floor, and align them before you continue.

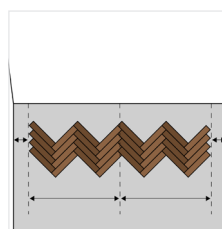
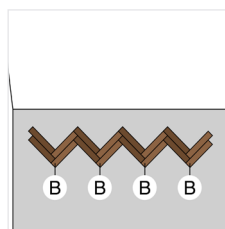
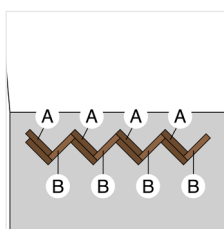

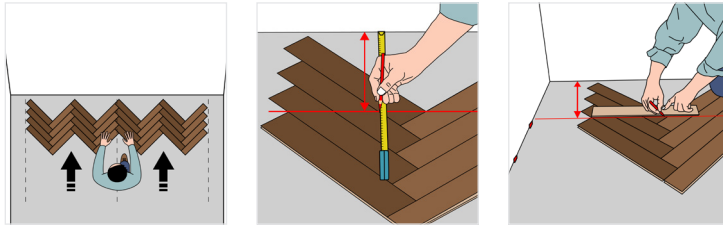

Shift the installed floor towards the starting wall and draw a cutting line across the whole row, parallel to the wall.

Now you have 2 options:

1. Add numbers to the planks before you unlock them and cut each plank separately. Then put them back in the right order against the wall. If wood glue has been applied, go to option 2.
2. Use tape to keep the planks together on both sides of the cutting line. Use blocks to lift the planks to cut them more easily. Or use a precision sawing machine to cut only the laminate. Shift the floor against the wall.

Option 1

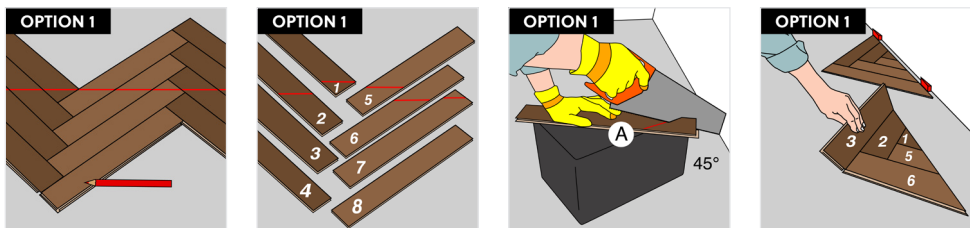

Option 2

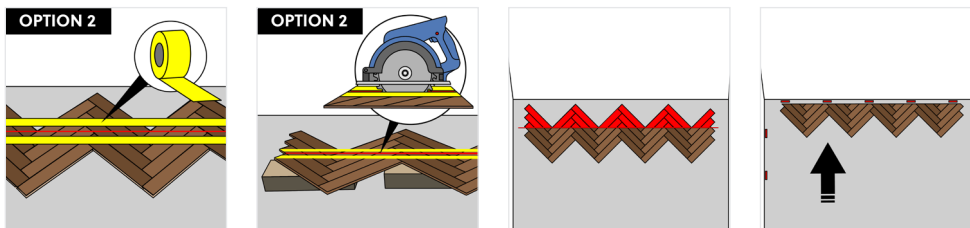

Remember to consider the expansion gap when measuring the size of the last planks in the row.

If using a hand saw, cut on the pattern side, if using an electrical jigsaw, always cut on the backside of the plank. A sharp saw blade is a must for the best result.

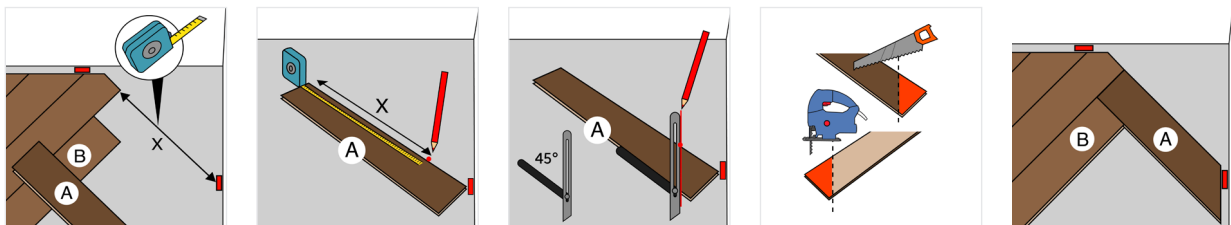

Continue the installation row by row: a series of A planks, and then a series of B planks. In the last row, you will have to cut the planks again.

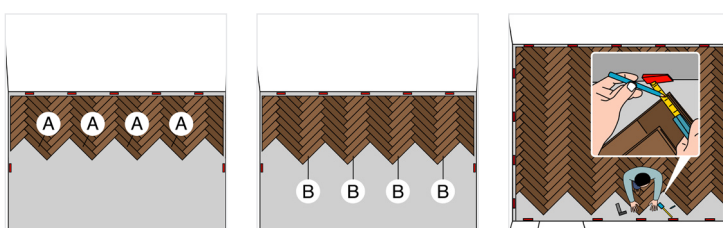

Measure the distance from the wall to the corner of the plank, where the laminate design ends. Consider the expansion gap!

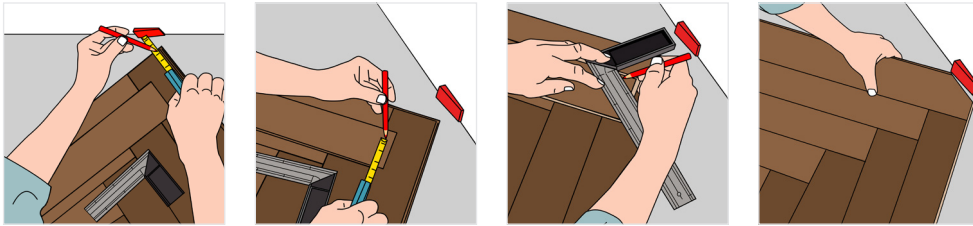

When installing the last planks, measure the remaining space (X and Y). Assemble a triangle of A and B planks and indicate the dimensions of X and Y to form a cutting line. Cut the planks and glue them one by one in the opening.

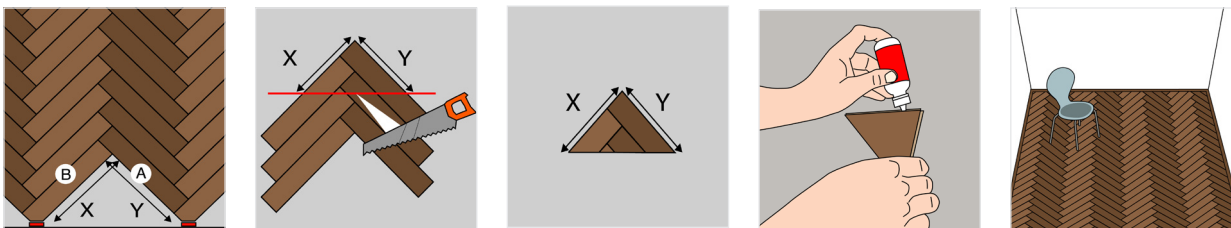

5.2 the shipdeck pattern

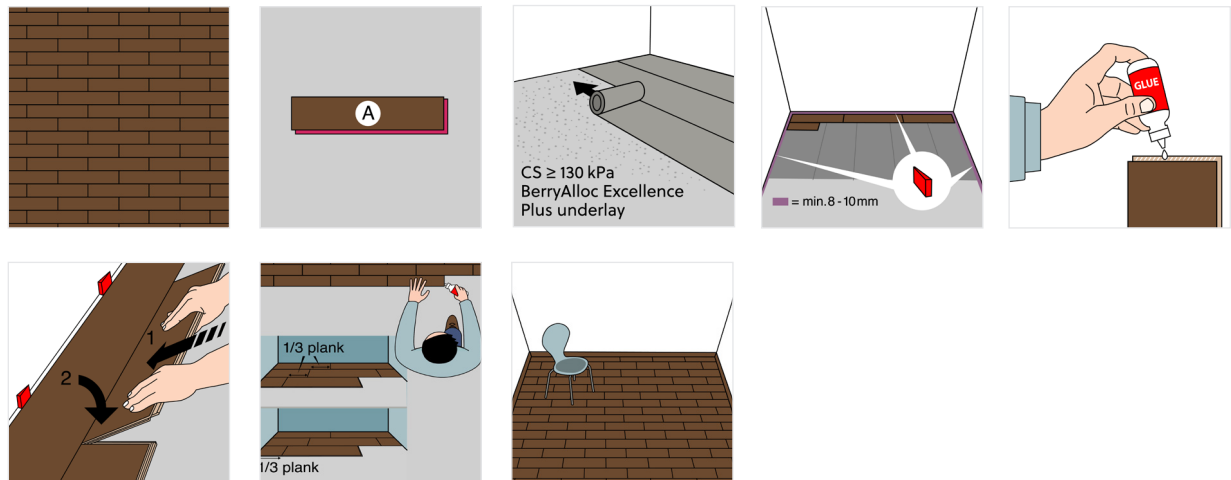

If you choose the shipdeck pattern, you only need A planks. Put a first plank in the corner of the room with the groove side pointing towards the direction of the installation. Apply glue to the short side of every plank before you install it. Make sure the joints of the planks are staggered by 1/3 of their length.

5.3 the ladder pattern

Chateau can also be installed as a ladder pattern, but this requires fully gluing it to the subfloor. This means no underlay can be used. Choose a high quality parquet glue for the best result. For this pattern, you only need A planks.

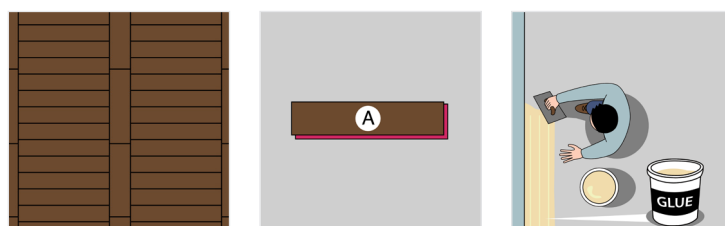

Carefully spread the glue on the subfloor and place a plank in the corner with the groove pointing towards you. Start with a first row against the wall and then continue with the ladder 'steps' in the perpendicular direction, with the long groove pointing towards the laying direction.



5.4 the mosaic pattern

For the classic Mosaic pattern, you need both plank types: A and B. This pattern is fully glued to the subfloor so no underlay is required.

Spread the glue and start with an A plank, with the groove pointing towards the laying direction. Install 6 A planks. Then switch the direction and continue with the 6 B planks, groove always pointing in the laying direction. Continue this fully glued installation square by square, row by row.

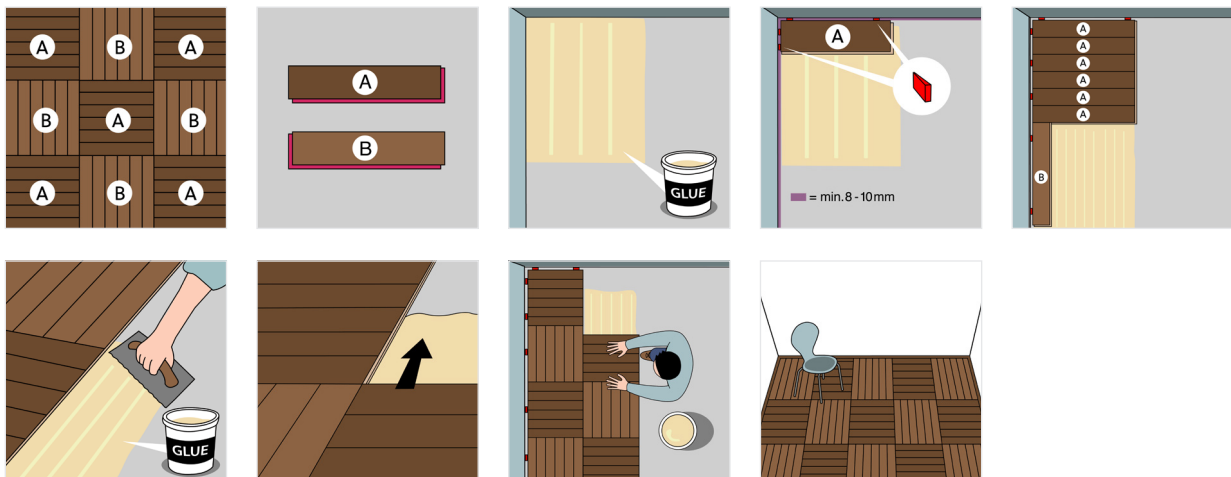

5.5 doorframes and heating pipes



Wooden doorframes should be shortened enough to make a plank and underlay fit underneath. Lay a panel facedown next to the doorframe. Saw the panel, then slide the plank under the doorframe. Keep an expansion gap under the doorframe of 8-10 mm!

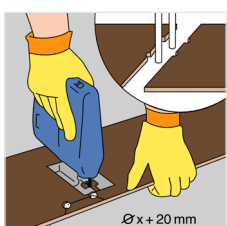

If you have heating pipes, measure their exact position and mark it on the laminate. Add 20 mm to the dimension of the pipe, because the laminate has to be able to move in all directions around the pipe. Saw in an angle of 45° from the drilling holes to the side of the laminate and put the laminate in place.

6. a perfect finish

BerryAlloc offers a wide range of accessories with a timeless design for the finishing touch:

- Skirtings 6 cm and 8 cm
- Quarter rounds
- Floor profiles: T-profile, reducer, end profile
- Aluminium floor profiles

Paintable white skirtings are also available and can be used unpainted, or painted in the same colour as your wall.

When installing accessories, always keep in mind that the floor needs to be able to move. This means:

- Skirtings should never be attached to the floor: they can be fixed to the wall with clips. In case your walls are not straight, use the BerryAlloc glue to fix the skirting to the wall.
- After installing a skirting or profile, do not seal/fix it to the laminate with sealant. The movement of the laminate will cause cracks in the sealing product which makes the sealant ineffective and unaesthetic.
- Joints on fixed building elements (doorframes, heating pipes, etc.) should never be completely sealed with elastic filler. Use a Fillertwine first and then finish with elastic filler: this allows the floor to move.
- Profiles, doorstops, and suchlike should not be screwed through the laminate into the subfloor.

7. care and maintenance

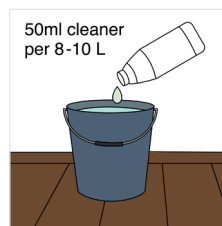
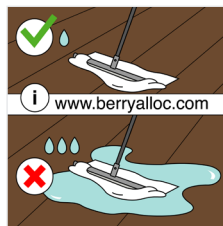
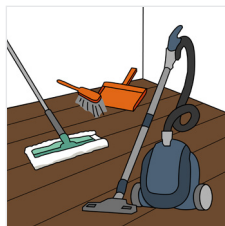

A laminate floor is very easy to clean:

DRY CLEANING: with a brush, mop with dry wipes or vacuum cleaner

WET CLEANING with a well wrung-out cloth – avoid using too much water!

Clean up any spilled liquids immediately.

We strongly recommend using the BerryAlloc laminate cleaner, it's specially developed to clean our laminate floors and leaves no traces. Never use steam cleaners on laminate.



Put doormats at every entrance to protect your laminate from dirt and sand.

Lift heavy furniture and put felt pads on the legs of your chairs. Use a protective floor mat under your castor chair.

Laminate cannot be polished or treated with products that contain wax or oil.

For more details: read our care and maintenance manual.

8. warranty

By following the instructions mentioned above, you will extend the longevity of your laminate flooring and ensure the validity of the warranty.

For more info, please refer to our warranty conditions and warranty policy.

enjoy your berryalloc floor!

/ chateau.

BERRY  ALLOC

**When
classy meets
contemporary.**



_____ herringbone laminate.

Timeless elegance.

Originally found in luxurious castles and stately manor houses, **herringbone** is a tried-and-true style that has more than withstood the test of time. Having taken the leap to contemporary living rooms, this floor remains the statement piece in each room: classy and sassy, it mixes modern and traditional into a unique eye-catcher. With this imposing pattern at your feet, you'll be living countless moments of joy in your own stylish stronghold.

relax, it's BerryAlloc





Chateau Java Brown

Beautiful. Carefree. What more could you want?

Treat yourself with a luxury floor.

Pretty and practical, could this be your dream floor? Give your home the upgrade that it deserves: the highly realistic wood designs of our herringbone Chateau collection will give you all that you were looking for in a floor that's extremely scratch resistant, easy to clean, and easy to maintain. This premium quality laminate will have you living like royalty in no time.

Make it trendy. Or make it your own.

The natural wood designs and unique small and narrow planks of our Chateau collection are perfect for recreating the beloved parquet herringbone style that's lasted centuries. This sophisticated look will add depth to any room, giving a guaranteed wow effect. But what if you don't want that sleek, classic look? Allow your creativity free rein by combining several colours and trying out different patterns. Take that wow-effect to the next level!



Chateau Charme Light Natural



herringbone
laminate

4

4 bevels



premium
quality



natural wood
design



scratch
resistant



lifetime
warranty



504 x 84 x 8 mm



1 box (A or B):
24 boards, 1,02 m²

1 pallet (A or B):
48 boxes, 48,77 m²

Discover the collection.

Choose between a broad and balanced range of decors to find the floor that's meant for you. Whether you choose the calming Charme decors, a feisty Java, or prefer to mix and match them all together, the floor you choose will be true to your personal style. One thing is certain, these natural colours will bring warmth to every home.



Charme Light Natural

Real Wood structure
62001190 (A)
62001166 (B)



Java Natural

Real Wood structure
62001405 (A)
62001407 (B)



Texas Light Brown

Real Wood structure
62001088 (A)
62001089 (B)

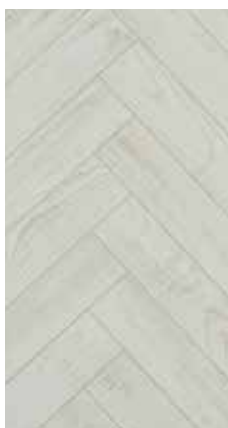

Chestnut White

Wood structure
62001162 (A)
62001194 (B)



Java Light Grey

Wood structure
62001183 (A)
62001164 (B)



Charme Black

Real Wood structure
62001191 (A)
62001167 (B)



Gyant Light
Real Wood structure – matt
62002160 (A)
61002162 (B)



Texas Light Natural
Real Wood structure
62002158 (A)
62002159 (B)



Bloom Sand Natural
Real Wood structure
62002172 (A)
62002173 (B)

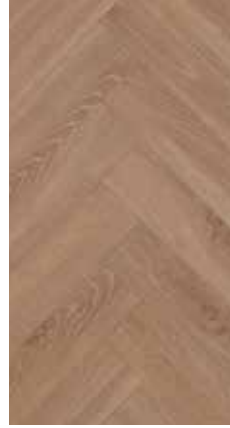

Bloom Light Brown
Real Wood structure
62002170 (A)
62002171 (B)



Java Brown
Real Wood structure
62001189 (A)
62001165 (B)



Chateau Charme Light Natural



Teak Brown
Wood structure – gloss
62001193 (A)
62001169 (B)



Merbau Brown
Wood structure – gloss
62001173 (A)
62001163 (B)

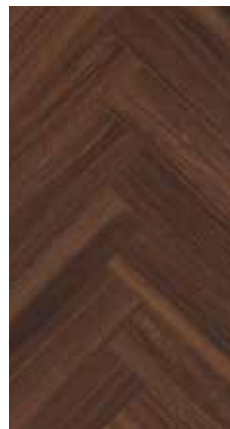

Walnut Brown
Wood structure – gloss
62002166 (A)
62002167 (B)

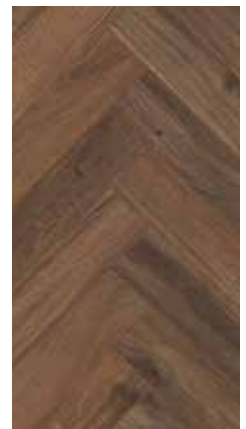

Gyant Dark Brown
Real Wood structure – matt
62002164 (A)
62002165 (B)



Installation tips.

Not sure how to get started? No worries. You'll find detailed installation instructions available in the packaging and on our website. When installing, keep the following tips in mind:

- Read the installation manual beforehand and closely follow each step.
- Use the Excellence Plus underlay for added stability and minimised walking sound.
- Use our matching accessories for a sophisticated finish.

Scan the QR code to watch the installation video.



Define your own style.

Who said you had to stick to the status quo? Chateau offers four different installation patterns. Time to get creative and choose the style that suits you best.



Herringbone
A & B planks



Shipdeck
A planks



Ladder
A planks, fully glued

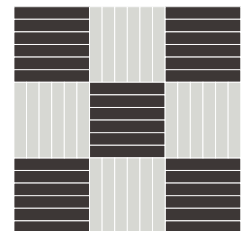

Mosaic
A & B planks, fully glued

It's all in the details.

Finish off your fabulous floor with the right accessories. Use our Excellence Plus underlay for added support and minimised walking sound. We also provide matching skirtings and profiles for a detailed finish.



Underlay

Excellence Plus reduces the impact sound with -21dB and is compatible with floor heating systems. (SEPLUS10)

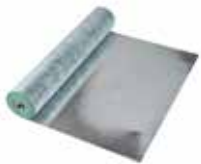

Laminate Cleaner

This biodegradable and fragrant laminate cleaner is suitable for both first-time maintenance and regular use. 1 litre. (LC1000)



100% matching skirtings



60 mm matching skirting

Installation: glue or clips
2400 x 12 x 60 mm
(L x W x H)



80 mm matching skirting

Installation: glue or clips
2400 x 12 x 80 mm
(L x W x H)



Quarter round, matching

Installation: glue
2400 x 14 x 14 mm
(L x W x H)

100% matching profiles



Matching T-Profile

1000 x 40 x 8 mm
2400 x 40 x 8 mm
(L x W x H)



Matching reducer profile

1000 x 45 x 12 mm
2400 x 45 x 12 mm
(L x W x H)



Matching end profile

2400 x 28 x 8 mm
(L x W x H)

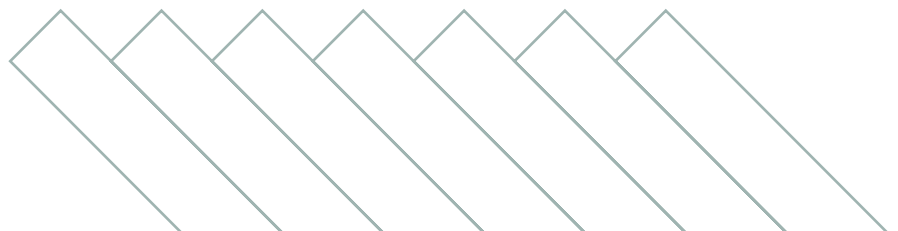



Chateau Chestnut White

BERRY  **ALLOC**

BerryAlloc NV
Industrielaan 100
8930 Menen, Belgium
T +32 56 67 66 11
info@berryalloc.com

berryalloc.com

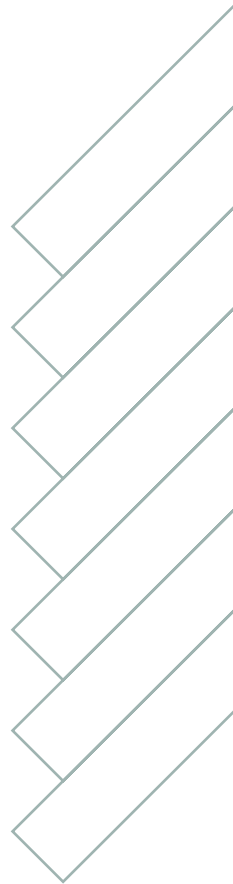



/ chateau.

For those 'queen of the chateau' moments.

BERRY ALLOC

herringbone laminate.

herringbone
AC 1000
made in Belgium

BERRY ALLOC

/ chateau.

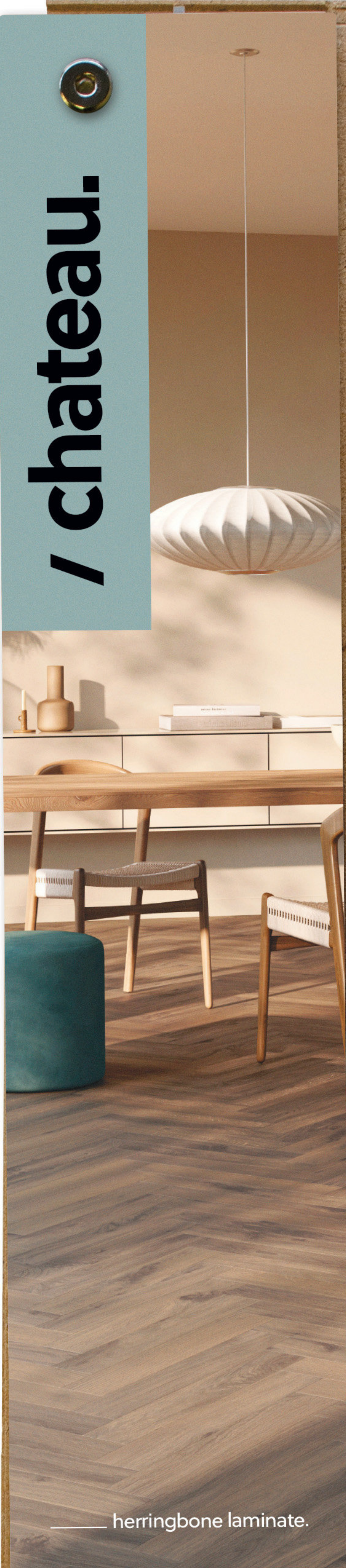

herringbone laminate.

BERRY  ALLOC

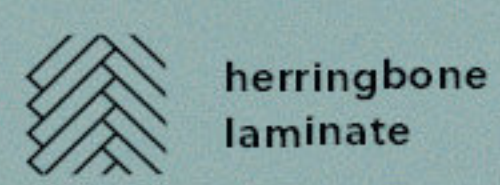

herringbone laminate

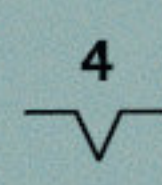

4 bevels



premium quality



natural wood design



scratch resistant

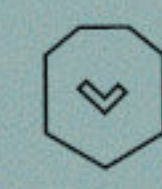

lifetime warranty